

MODEL : PA

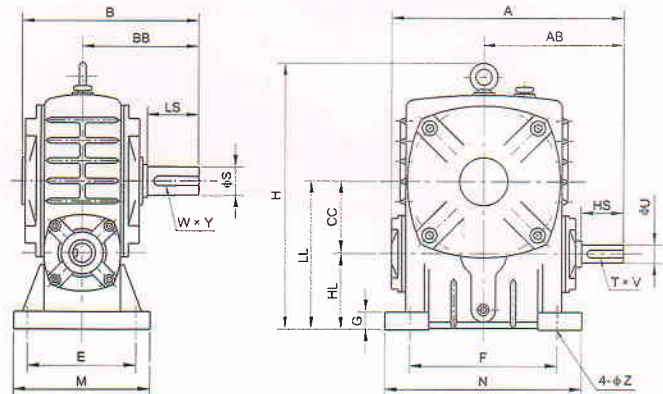

轴指向表示
Shaft Direction

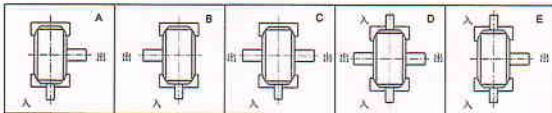

Size	Ratio	A	AB	B	BB	CC	E	F	G	H	HL	LL	M	N	Z	Input Shaft			Output Shaft			kg	L
																HS	U	T x V	LS	S	W x Y		
40		142	85	112	74	40	70	80	12	135	40	80	90	100	10	25	12	4 x 2.5	28	14	5 x 3	3.8	0.14
50		175	105	145	95	50	95	110	15	180	50	100	120	140	11	30	12	4 x 2.5	40	17	5 x 3	7	0.17
60	1/5	195	120	165	110	60	105	120	20	210	60	120	130	150	11	40	15	5 x 3	50	22	7 x 4	10.5	0.23
70	1/10	234	140	195	130	70	115	150	20	243	70	140	150	190	15	40	18	5 x 3	60	28	7 x 4	14.5	0.5
80	1/15	264	160	210	140	80	135	180	20	273	80	160	170	220	15	50	22	7 x 4	65	32	10 x 4.5	22	0.7
100	1/20	300	178	230	155	100	155	220	25	340	100	200	190	260	15	50	25	7 x 4	75	38	10 x 4.5	36	1.6
120	1/25	385	230	285	185	120	180	260	30	405	120	240	230	320	18	65	30	7 x 4	85	45	12 x 4.5	63	3.0
135	1/30	435	260	320	210	135	200	290	30	455	135	270	250	350	18	75	35	10 x 4.5	95	55	15 x 5	80	3.5
147	1/40	438	262	320	209	147	200	280	30	460	123	270	250	350	18	75	35	10 x 4.5	95	55	16 x 6	97	3.6
155	1/50	507	300	387	252	155	220	320	38	490	135	290	280	390	20	85	40	10 x 4.5	110	60	15 x 5	114	3.6
175	1/60	550	325	407	262	175	250	350	40	565	160	335	310	430	20	85	45	12 x 4.5	110	65	18 x 6	150	4.5
200		594	350	480	305	200	290	390	42	625	175	375	360	480	22	95	50	12 x 4.5	125	70	20 x 7	218	6.4
250		710	420	560	360	250	380	480	42	730	200	450	460	560	27	110	60	15 x 5	155	90	24 x 8	363	8.5

MODEL : PR



轴指向表示
Shaft Direction

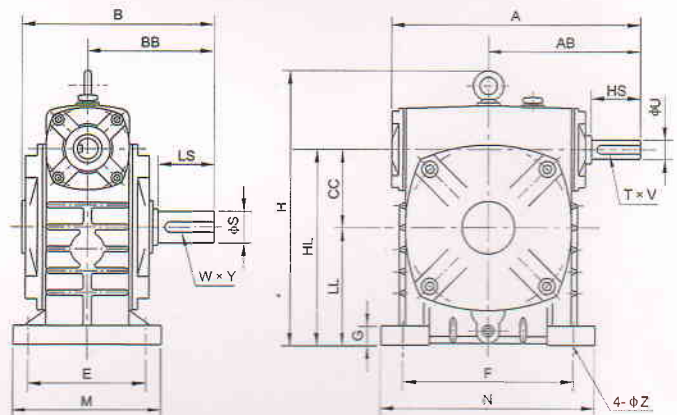
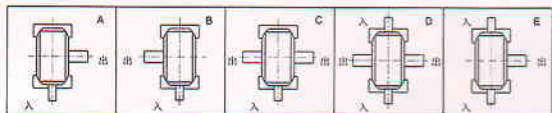

Size	Ratio	A	AB	B	BB	CC	E	F	G	H	HL	LL	M	N	Z	Input Shaft			Output Shaft			kg	L
																HS	U	T x V	LS	S	W x Y		
40		142	85	112	74	40	70	80	12	135	100	60	90	100	10	25	12	4 x 2.5	28	14	5 x 3	3.8	0.3
50		175	105	145	95	50	95	110	15	180	130	80	120	140	11	30	12	4 x 2.5	40	17	5 x 3	7	0.4
60	1/5	195	120	165	110	60	105	120	20	205	150	90	130	150	11	40	15	5 x 3	50	22	7 x 4	10.5	0.5
70	1/10	234	140	195	130	70	115	150	25	235	175	105	150	190	15	40	18	5 x 3	60	28	7 x 4	14.5	0.7
80	1/15	264	160	210	140	80	135	180	25	265	200	120	170	220	15	50	22	7 x 4	65	32	10 x 4.5	22	1.1
100	1/20	300	178	230	155	100	155	220	25	327	250	150	190	260	15	50	25	7 x 4	75	38	10 x 4.5	36	2.3
120	1/25	385	230	285	185	120	180	260	30	388	300	180	230	320	18	65	30	7 x 4	85	45	12 x 4.5	63	4.5
135	1/30	435	260	320	210	135	200	290	30	445	350	215	250	350	18	75	35	10 x 4.5	95	55	15 x 5	80	6.0
155	1/40	507	300	387	252	155	220	320	38	483	390	235	280	390	20	85	40	10 x 4.5	110	60	15 x 5	114	6.2
175	1/50	550	325	407	262	175	250	350	40	550	435	260	310	430	20	85	45	12 x 4.5	110	65	18 x 6	150	8.0
200	1/60	594	350	480	305	200	290	390	42	610	490	290	360	480	22	95	50	12 x 4.5	125	70	20 x 7	218	9.0
250		710	420	560	360	250	380	480	48	755	600	350	460	560	27	110	60	15 x 5	155	90	24 x 8	363	17.0